

PAMS Technical Documentation

Chapter 3

TRANSCEIVER TFE-2

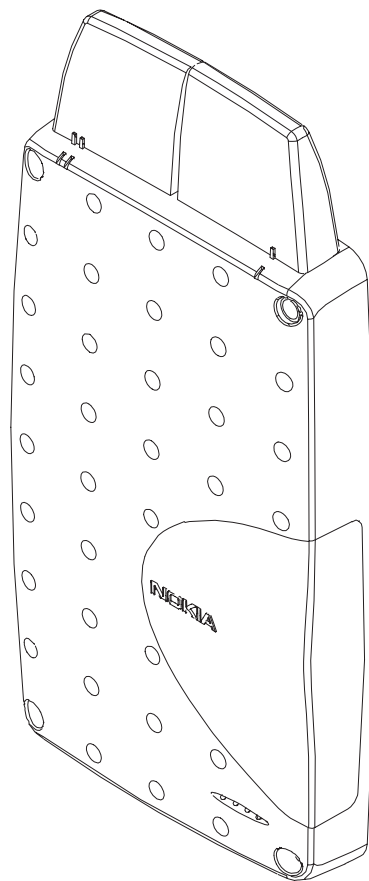

CONTENTS

	Page No
Introduction	1-3
Service Manual Structure	1-3
Company Policy	1-4
Warnings and Cautions	1-4
Warnings:	1-4
Cautions:	1-5
Introduction	1 - 5
Product and Module List	1 - 5
Exploded View of Transceiver TFE-2	1 - 6
Assembly Parts	1 - 7

Appendix Structure

This section of the service manual contains specific details for the TFE-2 handportable telephone

The section comprises three chapters as follows: Chapter 1, Foreword (this chapter); Chapter 2, Transceiver TFE-2, containing an exploded view of the TFE-2 variant (including a list of assembly parts) plus component parts lists covering the system module and the display module; which aims to provide all user information that service personnel are likely to require during servicing and repair of equipment.

NOTE: The Service Manual is intended for use by qualified service personnel only.

Company Policy

Our policy is of continuous development; details of all technical modifications will be included with service bulletins.

While every endeavour has been made to ensure the accuracy of this document, some errors may exist. If any errors are found by the reader, NOKIA MOBILE PHONES should be notified in writing.

Please state:

Title of the Document + Issue Number/Date of publication

Latest Amendment Number (if applicable)

Page(s) and/or Figure(s) in error

Please send to:

Nokia Mobile Phones
PAMS Technical Documentation
PO Box 86
24101 SALO
Finland

Warnings and Cautions

Please refer to the phone's user guide for instructions relating to operation, care and maintenance including important safety information. Note also the following:

Warnings:

1. CARE MUST BE TAKEN ON INSTALLATION IN VEHICLES FITTED WITH ELECTRONIC ENGINE MANAGEMENT SYSTEMS AND ANTI-SKID BRAKING SYSTEMS. UNDER CERTAIN FAULT CONDITIONS, EMITTED RF ENERGY CAN AFFECT THEIR OPERATION. IF NECESSARY, CONSULT THE VEHICLE DEALER/MANUFACTURER TO DETERMINE THE IMMUNITY OF VEHICLE ELECTRONIC SYSTEMS TO RF ENERGY.
2. THE HANDPORTABLE TELEPHONE MUST NOT BE OPERATED IN AREAS LIKELY TO CONTAIN POTENTIALLY EXPLOSIVE ATMOSPHERES EG PETROL STATIONS, BLASTING AREAS ETC. PERMISSION MUST BE OBTAINED TO USE THE PHONE IN AIRCRAFT.
3. OPERATION OF ANY RADIO TRANSMITTING EQUIPMENT, INCLUDING CELLULAR TELEPHONES, MAY INTERFERE WITH THE FUNCTIONALITY OF INADEQUATELY PROTECTED MEDICAL DEVICES. OTHER ELECTRONIC EQUIPMENT MAY ALSO BE SUBJECT TO INTERFERENCE.

Cautions:

1. Servicing and alignment must be undertaken by qualified personnel only.
2. Ensure all work is carried out at an anti-static workstation and that an anti-static wrist strap is worn.
3. Ensure solder, wire, or foreign matter does not enter the telephone as damage may result.
4. Use only approved components as specified in the parts list.
5. Ensure all components, modules screws and insulators are correctly re-fitted after servicing and alignment. Ensure all cables and wires are repositioned correctly.

Introduction

The TFE-2 terminal ensures connections for landline telephone and group 3 fax. These services are available in a very small and light WLL terminal.

Product and Module List

Unit/type:	Product code:	Module code:
Transceiver TFE-2	0630143	
• system module WT9		0201147
• mechanics MTFE1		0260876

Exploded View of Transceiver TFE-2

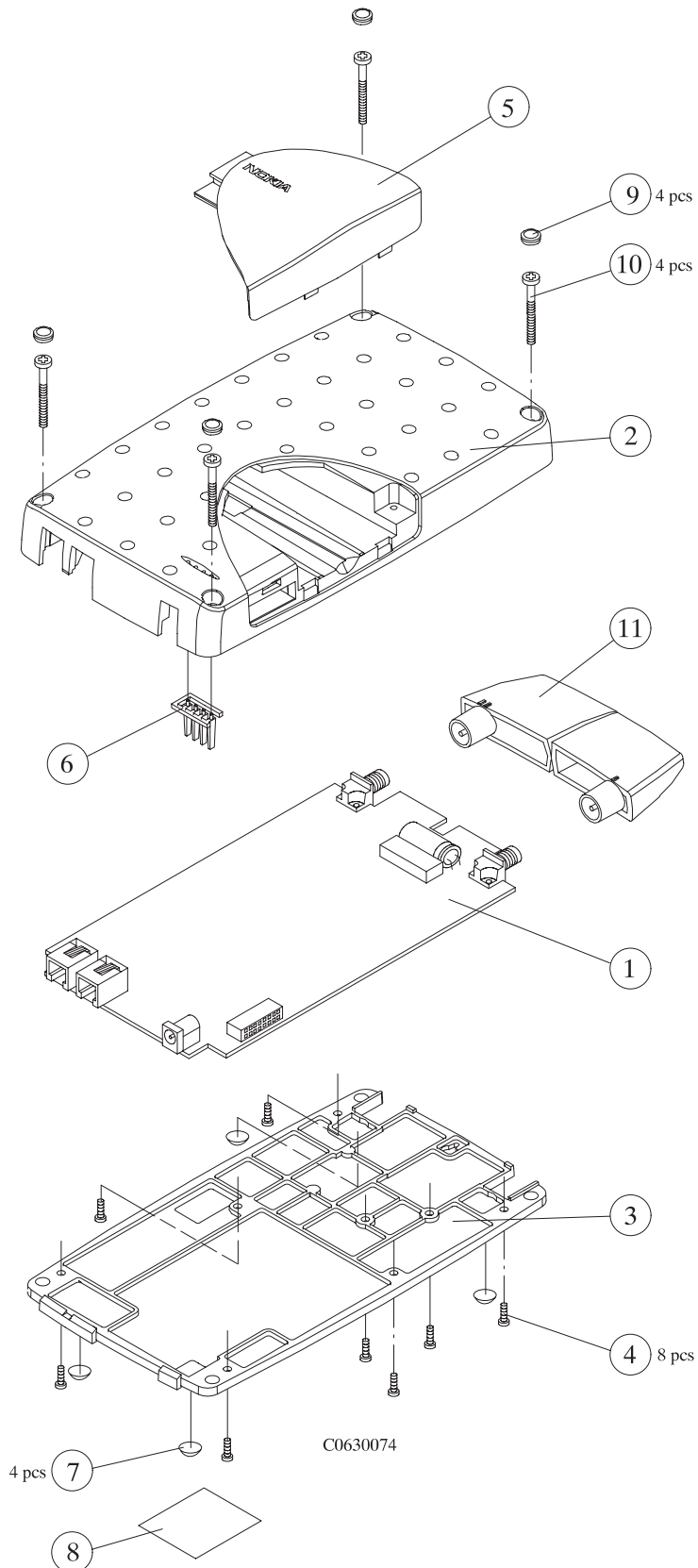

Assembly Parts

ITEM	Q'TY	CODE	DESCRIPTION	VALUE, TYPE
1		0201147	System module WT9	
2		9530009	A-cover	DMS00180
3		9530007	B-cover	DMS00181
4	8	6290033	Screw	M3x8 DIN7500C
5		9450786	Card-cover	
6		9450787	Light guide	
7	4	6501068	Adhesive foot	
8		9380155	Type label	4D 22453
9	4	9450876	Cover plug	
10	4	6290035	Screw	
11		0660133	Antenna	AHA-1E

This page intentionally left blank.